

C-Si GREEN PV MODULES

MBPV CAAP

MATERIALS

- **High Quality, High Transmission 3.2mm tempered Solar Glass**
- **Fast Cure EVA having superior UV and Thermal properties.**
- **Multilayered Back sheet giving weather-able barrier for modules and high performance in rugged environments around the world, high dielectric performance, superior partial discharge and electrical insulation properties.**
- **Sturdy New screw type anodized Aluminum frame design using double sided tape for framing.**
- **IEC and UL approved, IP 65 rated junction box assembly using USE-2 cable and UL approved connectors. Three Schottky bypass diodes used for preventing any damage due to shading.**

Typical Electrical Parameters	Unit	MBPV CAAP					
Nominal Power at STC, Pmax	[W]	180	190	200	210	220	225
Power tolerance at STC (min / max)	%	±3%					
Voltage at Pmax, Vmp	[V]	27.5	28.2	28.6	28.7	29.7	30.3
Current at Pmax, Imp	[A]	6.68	6.88	7.15	7.4	7.45	7.46
Open circuit voltage, Voc	[V]	35.5	35.7	36.05	36.2	36.3	36.6
Short Circuit Current, Isc	[A]	7.45	7.49	7.7	7.7	7.9	8.01
NOCT	°C	43.1					
Maximum System Voltage	V DC	1000					
Temperature Coefficient of Pmax	%/K	-0.43					
Temperature Coefficient of Voc	%/K	-0.34					
Temperature Coefficient of Isc	%/K	0.11					
IP Protection Level		IP 65					
Absolute Maximum Ratings							
Operating Temperature	°C	-40 to +85					
Storage temperature	°C	-40 to +85					
Mechanical Parameters							
Cell Type	mm	Multi Crystalline Cells					
Cell Size	mm	156 x 156					
No. of Cells (Matrix)	nos	60 (10 X 6)					
Module Overall Dimensions	mm	1661 X 991 X 40					
Weight (Approx.)	kg	19.5					
Maximum Wind Resistance	m/s	60					
Maximum Hail Diameter @80km/h	mm	25					
Note : STC : Irradiance 1000 W/m ² , Module Temperature at 25°C and AM 1.5 spectrum							

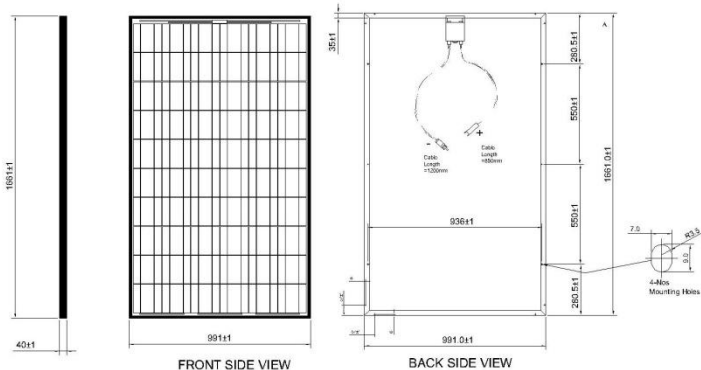

Frame Mounting Details

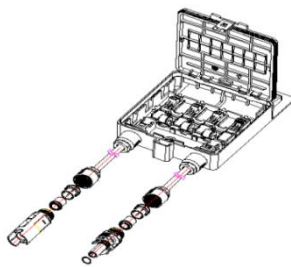

Junction Box

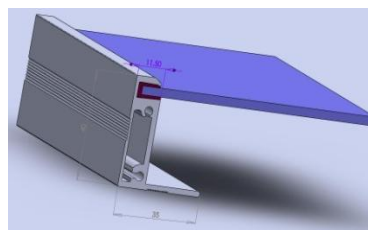

Frame Cross Sectional Detail

